

# Indicator

17-030350



<https://www.eao.com/component/17-030350/en/in...>

Your product:

---



## 17-030350 Indicator

### FRONT

<b>Front dimension:</b>	Ø 7 mm
<b>Front form:</b>	Round
<b>Front bezel material:</b>	Metal
<b>Reflector:</b>	Metal, polished chromium-plated, internal

### MOUNTING

<b>Design:</b>	Raised
<b>Mounting cut-out:</b>	Ø 6 mm
<b>Mounting type:</b>	Panel mounting

### OPERATING-/INDICATION PART

<b>Lens:</b>	round
<b>Illumination colour:</b>	Red

### ELECTRICAL CHARACTERISTICS

<b>Operating voltage:</b>	24 V AC/DC ±10 %
<b>Operation current:</b>	15 mA ±15 %
<b>Lumi. Intensity:</b>	8 mcd
<b>Polarity:</b>	Anode (+) Brass plug-in connector Cathode (-) Brass tinned plug-in connector

### MECHANICAL CHARACTERISTICS

<b>Terminal:</b>	Plug-in terminal, 2 x 0.5 mm
------------------	------------------------------

**Tightening torque:** Fixing nut max. 0.2 Nm

**Weight:** 0.003 kg

### AMBIENT CONDITION

**IP Protection:** IP40 front side, IP65 front side, according to IEC 60529

**Operating temperature:** - 20 °C ... + 60 °C

**Storage temperature:** - 25 °C ... + 80 °C

### CERTIFICATE

**Approbations:** UL

**Conformities:** 2011 / 65 / EC (RoHS), 2014 / 35 / EU (230 VAC)

**REACH:** REACH compliant

**RoHS:** RoHS compliant

### OTHER

**Short Description:** Indicator, Ø 6 mm, Ø 7 mm, Round, Metal, Plug-in terminal, 2 x 0.5 mm, Red

**Kind of illumination:** Single-LED

**Hints:** Connectors: Brass terminal = anode (+); brass tinned terminal = cathode (-)  
IP67 front side gap between LED and reflector and gap between reflector and frontplate sealed to IP67 when using the supplied gasket.  
The plastic is limited resistant to chemicals.

**Wiring diagrams:**

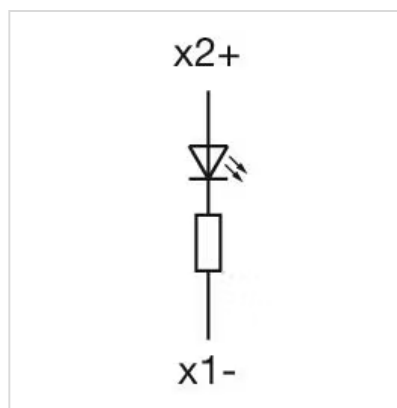

**Mounting cut-outs:**

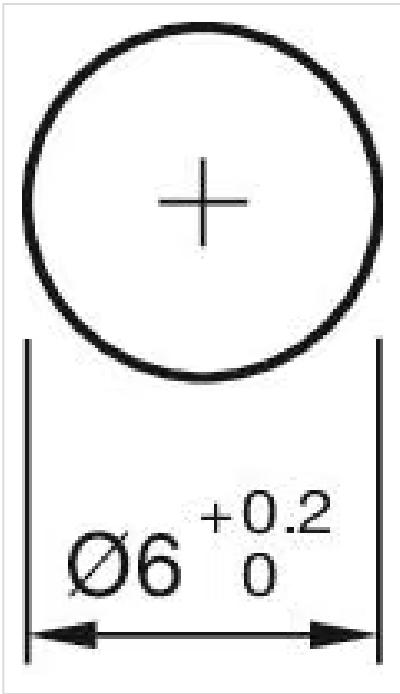

Dimension drawings:

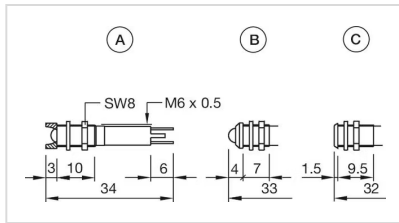

- A = interior
- B = exterior
- C = superflat