

# Actuator

704.084.7



<https://www.eao.com/p/704.084.7>

Your product:

---



## 704.084.7 Actuator

### FRONT

Front dimension:	Ø 40 mm
Front form:	Round
Front bezel colour:	Grey
Front bezel material:	Plastic

### MOUNTING

Design:	Raised
Mounting type:	Panel mounting

### OPERATING-/INDICATION PART

Lens colour:	Colourless
Lens material:	Plastic
Lens illumination:	Illuminated
Lens shape:	Mushroom-head
Lens optics:	opaque

### ELECTRICAL CHARACTERISTICS

Switching rating:

### MECHANICAL CHARACTERISTIC

Terminal:	Screw terminal
Switching action:	Momentary

**Mechanical lifetime:** ≤3 Mil. cycles of operation

**Weight:** 0.044 kg

## CERTIFICATE

**REACH:** REACH compliant

**RoHS:** RoHS compliant

## OTHER

**Short Description:** Actuator, Ø 40 mm, Mushroom-head, Illuminated, Colourless, Plastic, opaque, Round, Grey, Plastic, Momentary, Screw terminal

**Housing colour:** Grey

**Housing material:** Plastic

**Hints:** Max. 3 switching elements can be clipped on

**max. number of switching elements:** 3

**Wiring diagrams:**

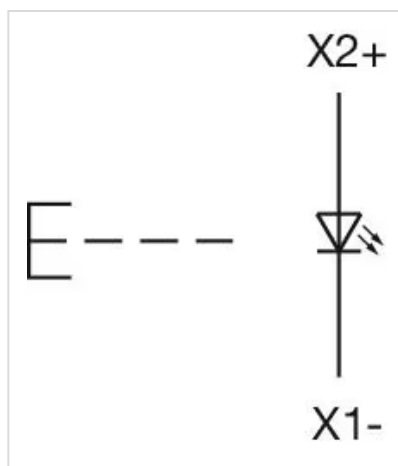

**Mounting cut-outs:**

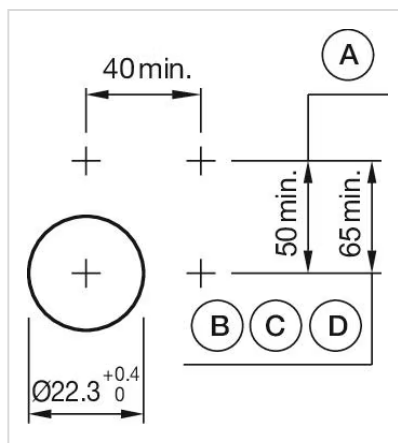

A = Screw terminal  
B = Push-in terminal (PIT)  
C = Plug-in terminal 6.3 mm x 0.8 mm  
D = Double plug-in terminal 6.3 mm x 0.8 mm

**Dimension drawings:**

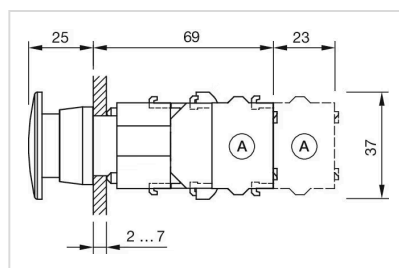

A = Screw terminal