

Pushbutton Ø 16 mm silver contact

82-4151.1000



<https://eao.com/p/82-4151.1000>

Your product:



82-4151.1000 Pushbutton Ø 16 mm silver contact

FRONT

Front dimension:	Ø 18 mm
Front form:	round
Front bezel material:	Stainless steel
Front bezel shape:	flush

MOUNTING

Mounting cut-out:	Ø 16 mm
Mounting type:	Panel mounting

OPERATING-/INDICATION PART

Lens colour:	Silver
Lens material:	Stainless steel
Lens illumination:	non illuminative
Lens shape:	flush
Lens optics:	opaque

ELECTRICAL CHARACTERISTICS

Contacts:	1 C
Rated Operational Voltage U_e:	250 VAC
Rated insulation voltage U_i:	250 V
Electrical lifetime:	50 000 cycles of operation
Electric strength:	1500 VAC, 50 Hz 1 minute between life terminals and ground

Pollution degree: 2, according to EN IEC 60947-1
Thermal current I_{th}: 5 A

MECHANICAL CHARACTERISTIC

Terminal: Soldering terminal, 2.8 x 0.5 mm
Contact material: Silver
Switching action: Momentary
Switching system: Snap-action switching element
Mechanical lifetime: 1 Mio. cycles of operation
Operating force: 4 N ... 7 N
Operating Travel: ca. 3 mm
Tightening torque: 0.5 ... 0.6 Nm
Weight: 0.018 kg

AMBIENT CONDITION

IP front protection: IP65, IP67
Operating temperature: - 30 °C ... + 70 °C
Storage temperature: - 40 °C ... + 80 °C
Shock resistance: Max. 500 m / s² as per IEC 60068-2-27
Vibration resistance: 10 ... 500 Hz, amplitude 1.5 mm p-p according to IEC 60068-2-6
Climate resistance: Damp heat, 21 days according to IEC 60512-11

CERTIFICATE

Approbations: CB, CCC, C UL, UL
Conformities: CE, 2011 / 65 / EC (RoHS), 2014 / 35 / EU (LVD)
REACH: REACH compliant
RoHS: RoHS compliant

OTHER

Short Description: Pushbutton Ø 16 mm silver contact, Momentary, 1 C, Soldering terminal, 2.8 x 0.5 mm, round, Stainless steel, Silver
Wiring diagrams:

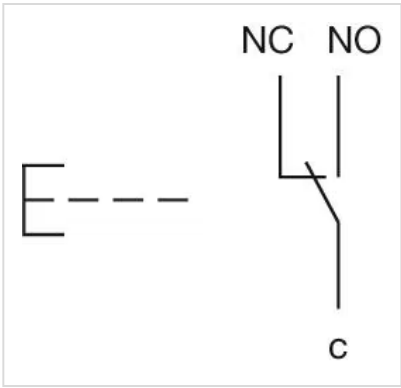

Component layouts:

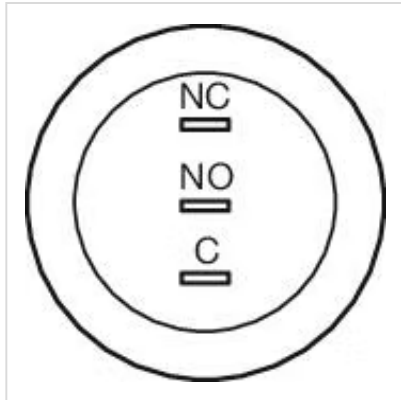

Mounting cut-outs:

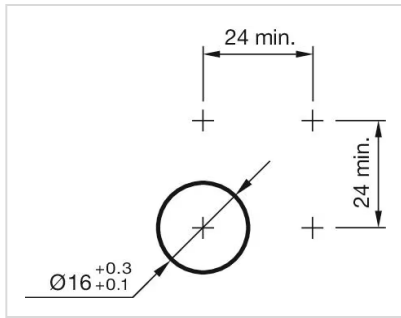

Dimension drawings:

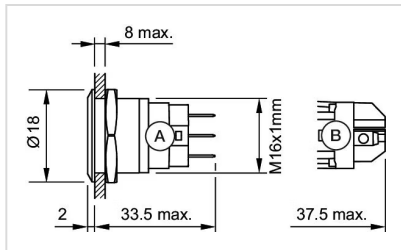

A = Solder terminal
B = Screw terminal