

Illuminated pushbutton Ø 16 mm silver contact

82-4151.1133



<https://eao.com/p/82-4151.1133>

Your product:



82-4151.1133

Illuminated pushbutton Ø
16 mm silver contact

FRONT

Front dimension:	Ø 18 mm
Front form:	round
Front bezel material:	Stainless steel
Front bezel shape:	flush

MOUNTING

Mounting cut-out:	Ø 16 mm
Mounting type:	Panel mounting

OPERATING-/INDICATION PART

Lens colour:	Silver
Lens material:	Stainless steel
Lens illumination:	illuminative
Lens shape:	flush
Lens optics:	opaque
Illumination colour:	Green
Shape of illumination:	Ring

ELECTRICAL CHARACTERISTICS

Contacts:	1 C
Operating voltage:	12 V AC/DC
Operation current:	7 mA

Switching voltage and switching current:	according to IEC 60947-5-1 (Silver contacts)	
	Service categorie AC-15	
	Voltage	Current
	24 VAC	1 A
	35 VAC	1 A (M12 versio
	110 VAC	1 A
	220 VAC	0.5 A
	Switch rating DC service categorie DC-13 (Silver contacts)	
	Voltage	Current
	24 VDC	0.7 A
35 VDC	0.5 A (M12 vers	
110 VDC	0.2 A	
220 VDC	0.1 A	

according to UL 508 (Silver contacts)	
cosφ 0,75 ... 0,8	
Voltage	Current
120 VAC	5 A
240 VAC	3 A
24 VAC	1 A

Rated Operational Voltage Ue:	250 VAC
Rated insulation voltage Ui:	250 V
Electrical lifetime:	50 000 cycles of operation
Electric strength:	1500 VAC, 50 Hz 1 minute between life terminals and ground
Pollution degree:	2, according to EN IEC 60947-1
Thermal current Ith:	5 A

MECHANICAL CHARACTERISTIC

Terminal:	Soldering terminal, 2.8 x 0.5 mm
Contact material:	Silver
Switching action:	Momentary
Switching system:	Snap-action switching element
Mechanical lifetime:	1 Mio. cycles of operation
Operating force:	4 N ... 7 N
Operating Travel:	ca. 3 mm
Tightening torque:	0.5 ... 0.6 Nm
Weight:	0.018 kg

AMBIENT CONDITION

IP front protection:	IP65, IP67
Operating temperature:	- 30 °C ... + 70 °C
Storage temperature:	

- 40 °C ... + 80 °C

Shock resistance: Max. 500 m / s² as per IEC 60068-2-27

Vibration resistance: 10 ... 500 Hz, amplitude 1.5 mm p-p according to IEC 60068-2-6

Climate resistance: Damp heat, 21 days according to IEC 60512-11

CERTIFICATE

Approbations: CB, CCC, C UL, UL

Conformities: CE, 2011 / 65 / EC (RoHS), 2014 / 35 / EU (LVD)

REACH: REACH compliant

RoHS: RoHS compliant

OTHER

Short Description: Illuminated pushbutton Ø 16 mm silver contact, Momentary, 12 V AC/DC, 1 C, Soldering terminal, 2.8 x 0.5 mm, round, Stainless steel, Green, Silver

Kind of illumination: Single-LED

Wiring diagrams:

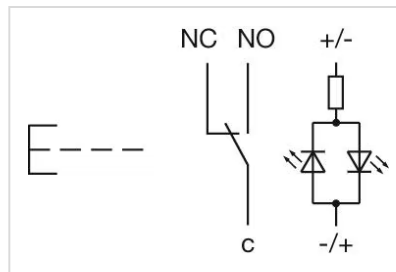

Component layouts:

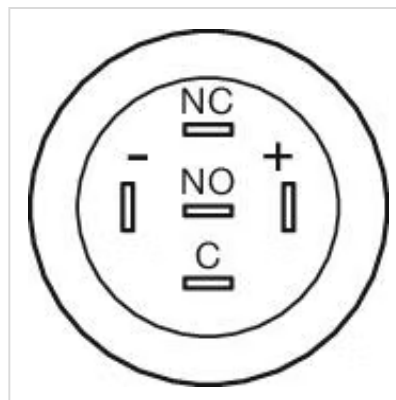

Mounting cut-outs:

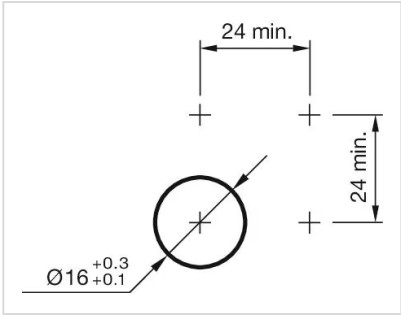

Dimension drawings:

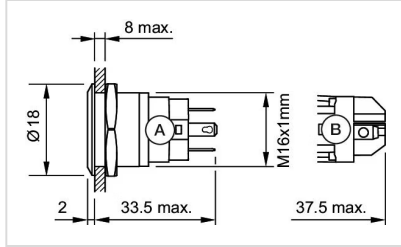

A = Solder terminal
B = Screw terminal