

Illuminated pushbutton Ø 22 mm silver contact

82-6151.2124.B002



<https://eao.com/p/82-6151.2124.B002>

Your product:



82-6151.2124.B002
Illuminated pushbutton Ø
22 mm silver contact

FRONT

Front dimension:	Ø 25 mm
Front form:	round
Front bezel material:	Stainless steel
Front bezel shape:	flush

MOUNTING

Mounting cut-out:	Ø 22 mm
Mounting type:	Panel mounting

OPERATING-/INDICATION PART

Lens colour:	Silver
Lens material:	Stainless steel
Lens illumination:	illuminative
Lens shape:	flush
Lens optics:	opaque
Symbol:	Standby
Illumination colour:	Blue
Shape of illumination:	Ring

ELECTRICAL CHARACTERISTICS

Contacts:	1 C
Operating voltage:	24 V AC/DC

Operation current: 7 mA

Switching voltage and switching current:

	according to IEC 60947-5-1 (Silver contacts)	
	Service categorie AC-15	
	Voltage	Current
	24 VAC	1 A
	35 VAC	1 A (M12 versio
	110 VAC	1 A
	220 VAC	0.5 A
	Switch rating DC service categorie DC-13 (Silver contacts)	
	Voltage	Current
	24 VDC	0.7 A
	35 VDC	0.5 A (M12 vers
	110 VDC	0.2 A
	220 VDC	0.1 A

	according to UL 508 (Silver contacts)	
	cosφ 0,75 ... 0,8	
	Voltage	Current
	120 VAC	5 A
	240 VAC	3 A
	24 VAC	1 A

Rated Operational Voltage Ue: 250 VAC

Rated insulation voltage Ui: 250 V

Electrical lifetime: 50 000 cycles of operation

Electric strength: 1500 VAC, 50 Hz 1 minute between life terminals and ground

Pollution degree: 2, according to EN IEC 60947-1

Thermal current Ith: 5 A

MECHANICAL CHARACTERISTIC

Terminal: Soldering terminal, 2.8 x 0.5 mm

Contact material: Silver

Switching action: Maintained

Switching system: Snap-action switching element

Mechanical lifetime: 500 000 cycles of operation

Operating force: 4 N ... 7 N

Operating Travel: ca. 3 mm

Tightening torque: 0.5 ... 0.6 Nm

Weight: 0.018 kg

AMBIENT CONDITION

IP front protection: IP65, IP67

Operating temperature:

- 30 °C ... + 70 °C

Storage temperature:

- 40 °C ... + 80 °C

Shock resistance:

Max. 500 m / s² as per IEC 60068-2-27

Vibration resistance:

10 ... 500 Hz, amplitude 1.5 mm p-p according to IEC 60068-2-6

Climate resistance:

Damp heat, 21 days according to IEC 60512-11

CERTIFICATE

Approbations:

CB, CCC, C UL, UL

Conformities:

CE, 2011 / 65 / EC (RoHS), 2014 / 35 / EU (LVD)

REACH:

REACH compliant

RoHS:

RoHS compliant

OTHER

Short Description:

Illuminated pushbutton Ø 22 mm silver contact, Maintained, 24 V AC/DC, 1 C, Soldering terminal, 2.8 x 0.5 mm, round, Stainless steel, Blue, Standby, Silver

Kind of illumination:

Single-LED

Wiring diagrams:

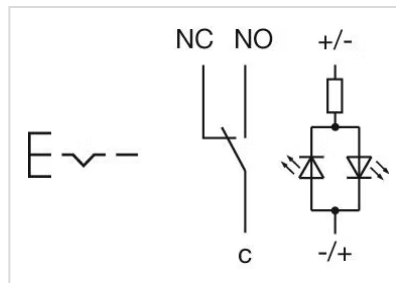

Component layouts:

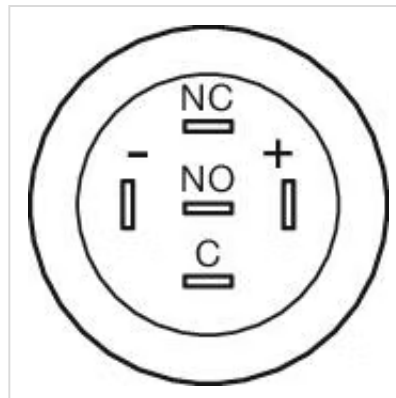

Mounting cut-outs:

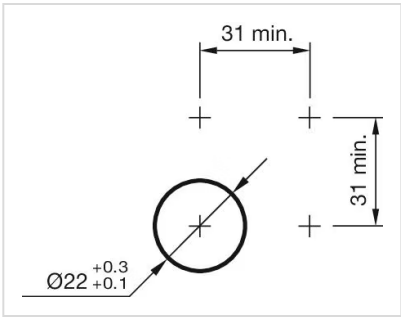

Dimension drawings:

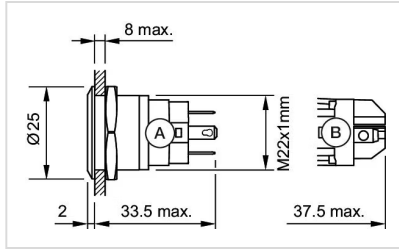

A = Solder terminal
B = Screw terminal