

Pushbutton, illuminated pushbutton, Ø 22 mm, stainless steel  
316L, cable 200 mm, 90°

82-665C.2000



<https://eao.com/p/82-665C.2000>

Your product:

---



82-665C.2000

Pushbutton, illuminated pushbutton, Ø 22 mm, stainless steel 316L, cable 200 mm, 90°

#### FRONT

<b>Front dimension:</b>	Ø 25 mm
<b>Front form:</b>	round
<b>Front bezel material:</b>	Stainless steel 316L
<b>Front bezel shape:</b>	flush

#### MOUNTING

<b>Mounting cut-out:</b>	Ø 22 mm
<b>Mounting type:</b>	Panel mounting

#### OPERATING-/INDICATION PART

<b>Lens colour:</b>	Silver
<b>Lens material:</b>	Stainless steel 316L
<b>Lens illumination:</b>	non illuminative
<b>Lens shape:</b>	flush
<b>Lens optics:</b>	opaque

#### ELECTRICAL CHARACTERISTICS

<b>Rated Operational Voltage <math>U_e</math>:</b>	250 VAC
<b>Rated insulation voltage <math>U_i</math>:</b>	250 V
<b>Switching rating:</b>	35 V AC/DC @ 0,6 A
<b>Electrical lifetime:</b>	50 000 cycles of operation
<b>Electric strength:</b>	1500 VAC, 50 Hz 1 minute between life terminals and ground

**Pollution degree:** 2, according to EN IEC 60947-1  
**Thermal current I<sub>th</sub>:** 5 A

### MECHANICAL CHARACTERISTIC

**Terminal:** Cable 200 mm, 90°  
**Switching action:** Maintained  
**Switching system:** Snap-action switching element  
**Mechanical lifetime:** 500 000 cycles of operation  
**Operating force:** 4 N ... 7 N  
**Operating Travel:** ca. 3 mm  
**Tightening torque:** 0.5 ... 0.6 Nm  
**Weight:** 0.04 kg

### AMBIENT CONDITION

**IP front protection:** IP65, IP67  
**Operating temperature:** – 30 °C ... + 70 °C  
**Storage temperature:** – 40 °C ... + 80 °C  
**Shock resistance:** Max. 500 m / s<sup>2</sup> as per IEC 60068-2-27  
**Vibration resistance:** 10 ... 500 Hz, amplitude 1.5 mm p-p according to IEC 60068-2-6  
**Climate resistance:** Damp heat, 21 days according to IEC 60512-11

### CERTIFICATE

**Conformities:** CE, 2011 / 65 / EC (RoHS), 2014 / 35 / EU (LVD)  
**REACH:** REACH compliant  
**RoHS:** RoHS compliant

### OTHER

**Short Description:** Pushbutton, illuminated pushbutton, Ø 22 mm, stainless steel 316L, cable 200 mm, 90°, Maintained, 35 V AC/DC @ 0,6 A, Cable 200 mm, 90°, round, Stainless steel 316L, Silver  
**Hints:** Cable with certification ECE-R118  
**Wiring diagrams:**

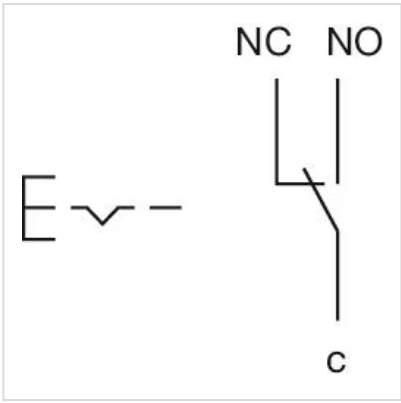

**Component layouts:**

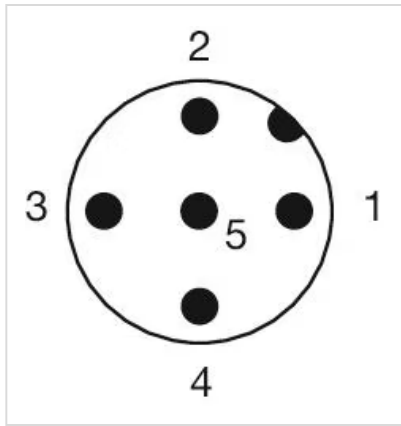

- 1 = Shield
- 2 = Red (AWG22)
- 3 = Black (AWG22)
- 4 = White (AWG24)
- 5 = Blue (AWG24)

**Mounting cut-outs:**

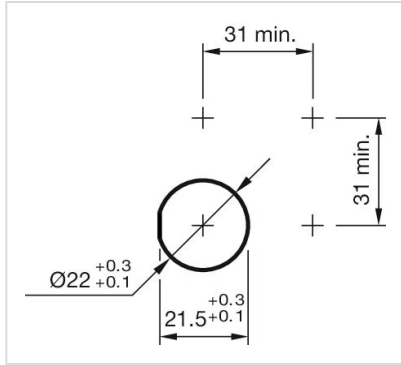

**Dimension drawings:**

