

PCB plug-in base

82-922



<https://www.eao.com/p/82-922>

Your product:



82-922

PCB plug-in base

MECHANICAL CHARATERISTIC

Terminal: PCB terminal

Weight: 0.001 kg

OTHER

Short Description: PCB plug-in base, PCB terminal, Axial

Titel Accessory: PCB plug-in base

Product attributes: For 19 and 22 mm

Pins: Axial

Component layouts:

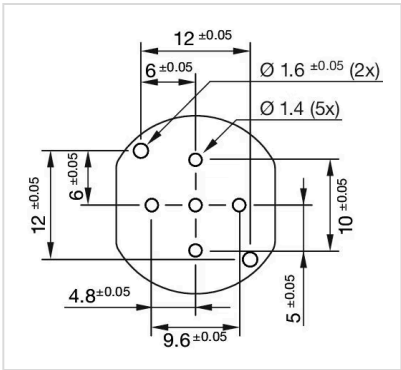

Dimension drawings:

