

## PCB plug-in base

84-920

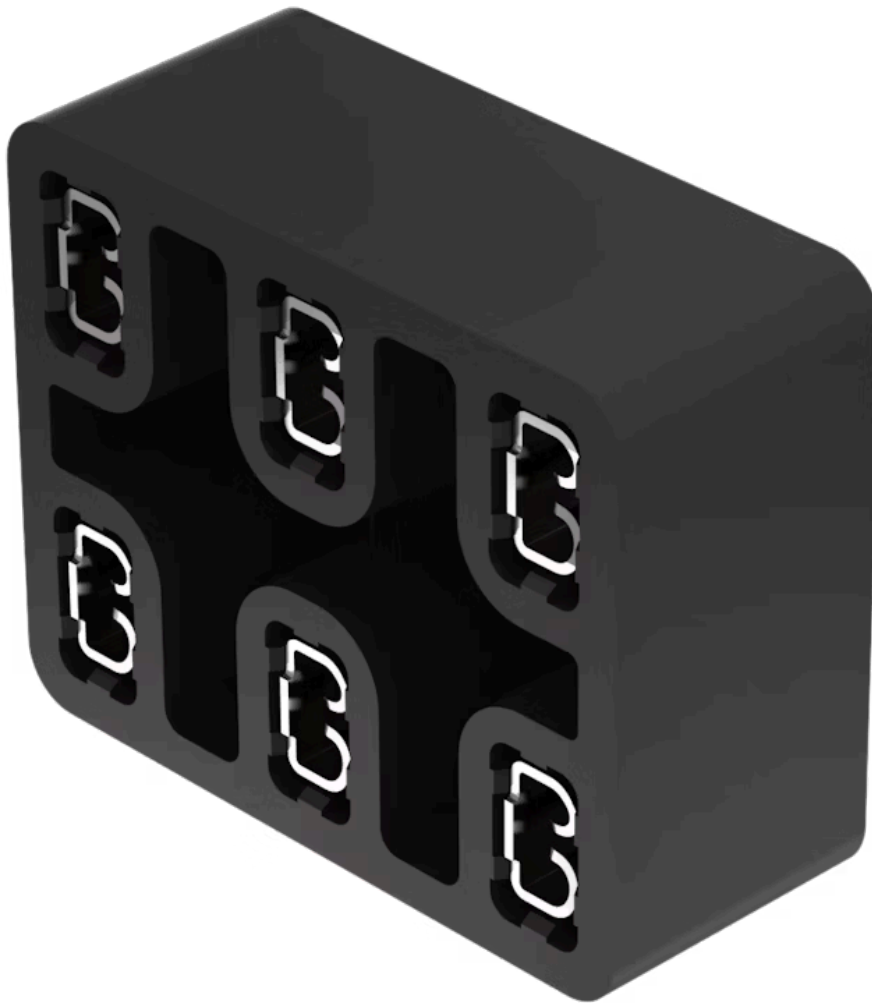

<https://www.eao.com/component/84-920/en/pcb-p...>

Your product:



# 84-920

## PCB plug-in base

### MECHANICAL CHARACTERISTICS

Terminal:	PCB terminal
Weight:	0.003 kg

### OTHER

Short Description:	PCB plug-in base, 20.3 mm x 15.8 mm x 8.3 mm, Metal / plastic, PCB terminal, Axial
Titel Accessory:	PCB plug-in base
Dimension:	20.3 mm x 15.8 mm x 8.3 mm
Material:	Metal / plastic
Product attributes:	For Emergency stop switch, stop switch
Pins:	Axial
Suitable for connection:	Plug-in terminal
Component layouts:	

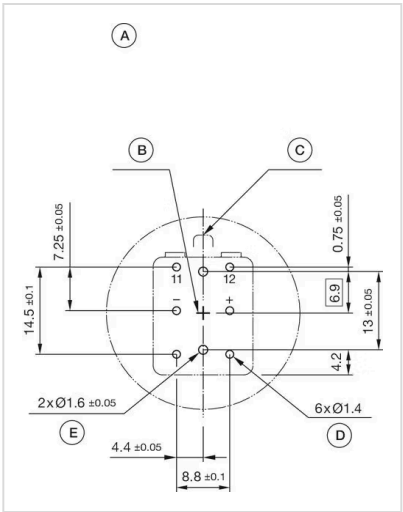

A = Drilling plan (component side)  
B = Centre from switch  
C = Anti-twist protection  
D = Pins for contacts/LED  
E = Positioning hole

### Dimension drawings:

