

# Housing pole mounting Ø 35 mm

84-9500.4



<https://www.eao.com/component/84-9500.4/en/ho...>

Your product:

---



## 84-9500.4

### Housing pole mounting Ø 35 mm

#### FRONT

**Colour:** Yellow

#### MOUNTING

**Mounting cut-out:** Ø 22.5 mm

**Mounting type:** pole mounting Ø35mm

#### MECHANICAL CHARACTERISTICS

**Weight:** 0.035 kg

#### CERTIFICATE

**REACH:** REACH compliant

**RoHS:** RoHS compliant

#### OTHER

**Short Description:** Housing pole mounting Ø 35 mm

**Dimension:** Ø 35 mm x 111 mm x 38.7 mm

**Material:** Plastic

**Product attributes:** Housing pole mounting Ø 35 mm

**Hints:** Screws are not contained in the scope of supply  
Please note: The cut-out of the pole must read min. 22 mm and needs to be aligned with the switch

**Colour RAL:** 1023 RAL

**Mounting cut-outs:**

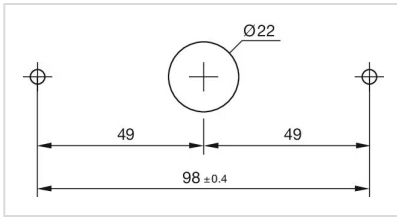

**Dimension drawings:**

